

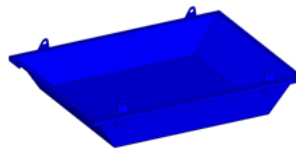

OPERATIONAL SAFETY AND ASSEMBLY INSTRUCTIONS

TRASH TRAY

Models: TT-6048-13; TT-8048-19



READ THESE INSTRUCTIONS CAREFULLY BEFORE USING THIS PRODUCT. KEEP THIS MANUAL HANDY FOR FUTURE REFERENCE.



READ BEFORE BEGINNING ASSEMBLY AND USE

FAILURE TO READ, UNDERSTAND AND FOLLOW ALL SAFETY RULES AND ASSEMBLY INSTRUCTIONS IN THIS MANUAL BEFORE ASSEMBLING, INSTALLING, USING OR SERVICING OF THE PRODUCT IS A MISUSE OF THE PRODUCT AND COULD RESULT IN SERIOUS INJURY OR DEATH. IF AFTER READING THE MANUAL YOU DO NOT UNDERSTAND AN INSTRUCTION, ASK YOUR SUPERVISOR OR EMPLOYER FOR CLARIFICATION.

JESCRAFT IS NOT LIABLE FOR ANY INJURY OR PROPERTY DAMAGE THAT OCCURS AS A CONSEQUENCE OF FAILING TO APPLY EITHER: a) THE INSTRUCTIONS IN THIS MANUAL; OR b) INFORMATION PROVIDED ON LABELS AFFIXED TO THIS PRODUCT. NEITHER IS JESCRAFT RESPONSIBLE FOR ANY CONSEQUENTIAL DAMAGES OR INJURYS SUSTAINED AS A RESULT OF FAILING TO EXERCISE SOUND JUDGMENT WHILE ASSEMBLING, INSTALLING, USING OR MAINTAINING THIS PRODUCT.



METAL CONDUCTS ELECTRICITY:

Do not use this equipment where contact may be made with power lines or other live electrical circuits.



DO NOT OVERLOAD:

This Trash Tray is designed to support a maximum load of either 800 lbs. for model# TT-6048-13; or 1,200 lbs. for model# TT-8048-19. DO NOT EXCEED THE MAXIMUM LOAD LIMIT OF TRASH TRAY.



OPERATION AND SAFETY

- Do not use this equipment if you are in poor health, taking medications, drugs, or have been consuming alcohol, all of which may impair your ability to work safely with this product.
- Always use Trash Tray in compliance with local or national laws, regulations, codes, and any other standards enforced in the location where the product is used. This is the responsibility of the owner/user.
- Inspect product before each use. Do not use if damaged or if any unusual noise or movement is observed. Check for wear of tray and all weld seams especially hoisting lugs to ensure they have not been compromised.
- Examine thoroughly to make sure Trash Tray is set up properly with the appropriate four leg cable/sling assembly. See page 2 and 3 for additional sling information.
- All components must be complete, functioning properly. If a malfunction occurs, remove the product from service and notify your supervisor and maintenance personnel about the issue.
- Keep the product clean & dry. Proper use, maintenance, and storage are essential for this product to function safely.
- Use the right product for the job. Do not modify the Trash Tray and do not use the product for a purpose for which it was not intended.
- Do not exceed the maximum load capacity of 800 lbs. for model TT-6048-13 or 1,200 lbs. for model# TT-8048-19.
- Always distribute objects within the Trash Tray evenly. Uneven weight distribution could cause tipping and material/debris to fall out.
- Be aware of dynamic loading. Suddenly dropping or bouncing a load into the Tray may create, for a brief instant, an excess load, which may result in damage to the product and/or personal injury.
- Trash Tray must be loaded and unloaded on solid flat surfaces.
- Trash Tray must be used on a firm surface that is free of pits, debris, holes or obstructions.
- Acids are corrosive and can seriously affect strength. Do not expose this product to corrosive substances.
- Never move a Trash Tray with a worker within.
- Use extra caution near operating machinery.
- Do not modify this product or any of its components.
- Do not remove any labels from this product.
- Always use this product in accordance with the instructions in this manual and consistent with any training relevant to machines, devices, materials, etc. used in conjunction with this product.



OPERATIONAL SAFETY AND ASSEMBLY INSTRUCTIONS

| MODEL | LENGTH (IN) | WIDTH (IN) | LIP HEIGHT (IN) | OA. HEIGHT (IN) | EMPTY WEIGHT (LBS) | LIFTING CAPACITY (LBS) | GROSS WEIGHT (LBS) |
|------------|-------------|------------|-----------------|-----------------|--------------------|------------------------|--------------------|
| TT-8048-19 | 79.25 | 47.75 | 13 | 17.3 | 145 | 1200 | 1345 |
| TT-6048-13 | 60 | 47.75 | 13 | 17.3 | 115 | 800 | 915 |

4 LEG LIFTING SLING RECOMMENDED

EACH LIFTING LEG MUST BE RATED FOR A MINIMUM OF 1150 LBS AT 70 DEGREES

CABLE LIFTING ANGLE SHALL NOT GO BELOW 45 DEGREES AS A MINIMUM, AND 70 DEGREES AS A MAXIMUM

EACH LEG OF THE LIFTING SLING SHALL NOT BE LESS THAN 3FT AS A MINIMUM, AND NOT EXCEED 6FT AS A MAXIMUM

Below is a link to an appropriate type lifting sling; choose correct length based on Trash Tray model recommended length.

<https://www.mcmaster.com/8952T51-8952T502/>

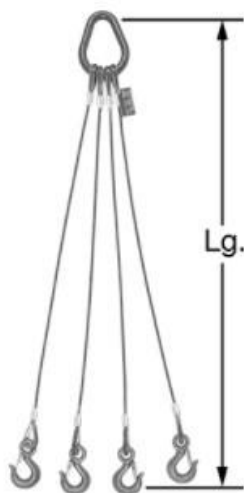

Four Leg

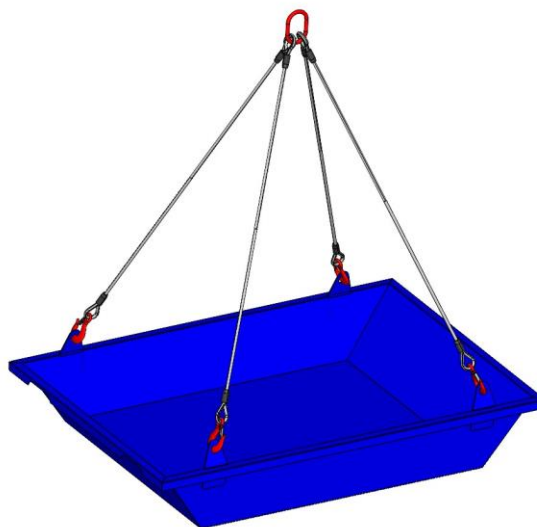

USE A SIMILAR SLING CONFIGURATION AS ABOVE

RECOMMENDED LENGTHS FOR EACH MODEL: TT-8048-19 = 5FT SLING; TT-6048-13 = 3FT SLING

NEVER EXCEED THE MAXIMUM LOAD LIMIT OF TRASH TRAY.

TRASH TRAY IS NOT DESIGNED FOR CARRYING OR LIFTING GRAVEL, TRASH TRAYS ARE ONLY DESIGNED FOR REMOVAL OF TEAR-OFF DEBRIS.

NEVER STAND UNDER TRASH TRAY, STAY OUT OF LINE OF FORCE IN ANY DIRECTION



OPERATIONAL SAFETY AND ASSEMBLY INSTRUCTIONS

WARNING

This device must only be used for its intended purpose. Do NOT make alterations to this device. Risks are high for serious injury or death when working around suspended loads. Place on level surfaces only, capable of supporting weight of tray including material held. The operator must never carry the load over people and it is best to have a 10 Ft. clear radius. This requires that no one is allowed to be within 10 Ft. of the area in which the load would fall if a failure occurred. Do not allow anyone to ride in the Trash Tray or on the load. The Trash Tray must not be used to elevate personnel. Do not make any repairs or modifications.

WARNING

Before the load is raised make sure slings, chains or straps are properly secured and are not twisted around each other or entangled. Do not leave suspended loads unattended. Keep all personnel clear while the load is being raised, moved or lowered. Load must be sufficiently even that the bin is within 5 degrees of level when lifted. Crane operator should be watchful of the load at all times, especially when it is in motion. Never allow anyone to work under a suspended load. Never exceed the rated capacity of any part of the lifting system. Make sure the crane or lift used is rated for the load that will be carried plus the empty weight of the Trash Tray and weight of rigging. The load should not hang over or extend above the sides. Failure to comply with the above warning may cause the load to shift, possibly resulting in property damage, personal injury or death.

Working Load Limit (WLL)

The Working Load Limit as stated per Model# should be uniformly applied over the floor of the tray and is the maximum load which should ever be applied to the product. All ratings are based upon usual environmental conditions and consideration must be given to unusual conditions such as extreme high or low temperatures or winds, prolonged exposure to elements, etc. Never exceed the Working Load Limit.

Avoid shock loads as they may exceed the Working Load Limit.

A shock load can result from rapid change of movement, such as impacting, jerking or swinging of a static load. Sudden release of tension is another form of shock loading. Shock loads are generally significantly greater than static loads.

User Responsibility

1. Utilize appropriate rigging gear suitable for overhead lifting which meets industry standards. Rigging lines must have an angle to horizontal of at least 45 degrees.
2. Conduct inspection and maintenance of the Trash Tray and rigging gear for damage before and after each use in accordance with ASME B.30.20.2010. If damage is found do Not use the Trash Tray.
3. Provide employees with training to meet OSHA and ASME (B30.9, B30.26, etc.) requirements. Refer to all other applicable OSHA, ASME, ANSI or CSA codes and regulations for the proper use of this equipment.
4. Failure to understand and follow all safety rules, regulations and instructions could result in serious injury or death.

All photos, drawings and depictions in this booklet are for reference purposes only and may differ from actual product. Refer to applicable OSHA, ANSI or CSA codes and regulations for the proper use of this equipment.